

# Fully automatic lines for chemical strengthening of glass



Source: Tata



Source: Mercedes



Source: Tesla

## HISTORY of JSJ-Group

JSJ Jodeit, Jena	1991
(EFR, Glass activities)	2009
(IGM, Tube drawing)	2012
Glamaco, Coswig (founded in 1957)	2014
JSJ Glass Technology (Shenyang), China	2018

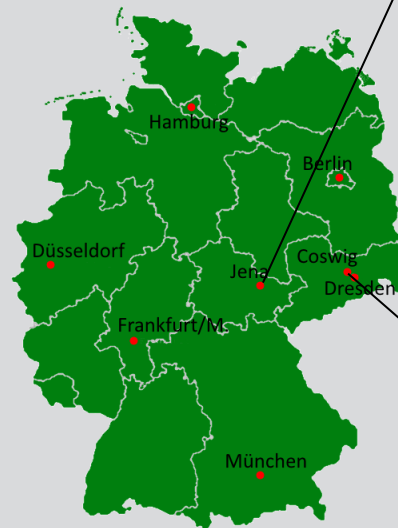

## Principle of chemical strengthening of glass: Ion exchange in a salt bath at 380°C to 450°C

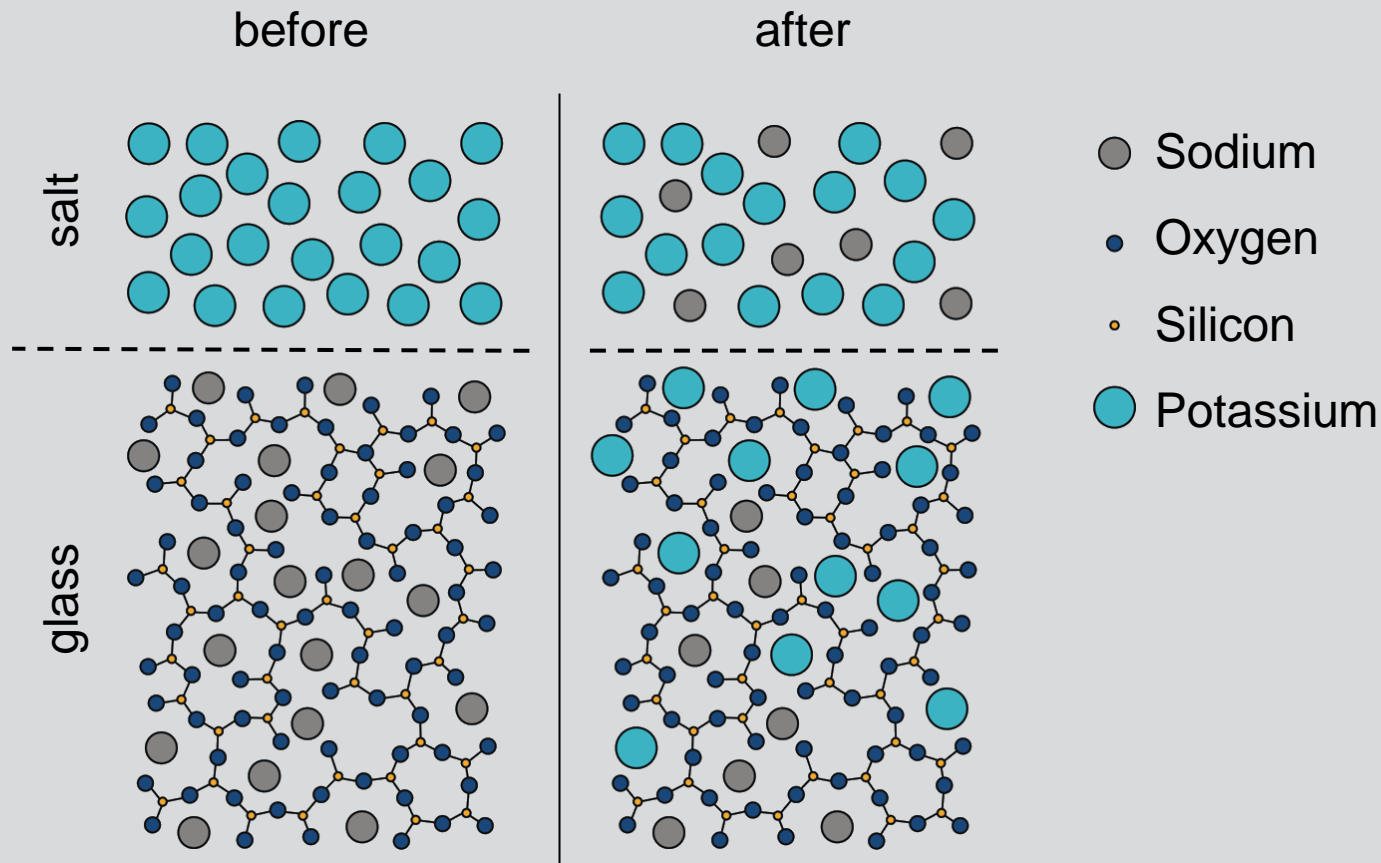

## Characteristics

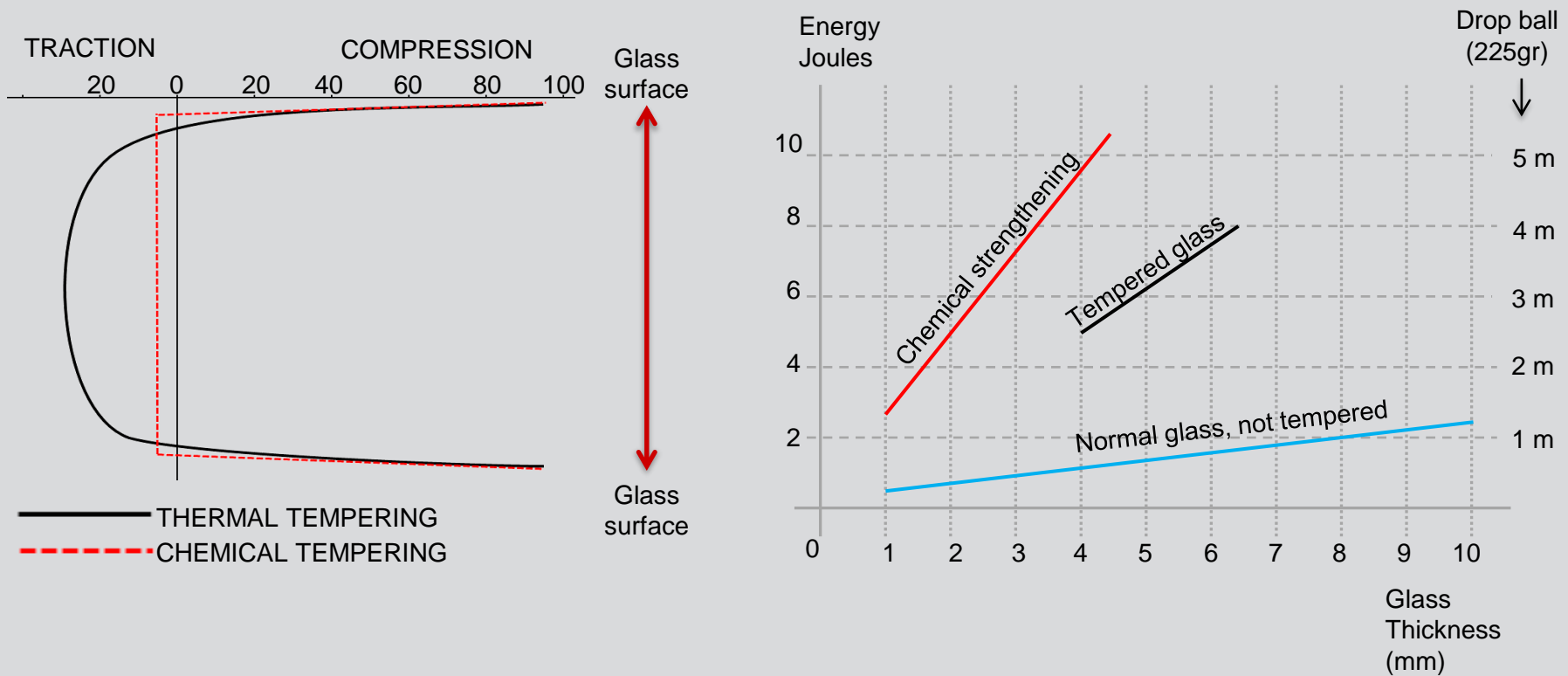

Values of CS by

Double ring bending strength

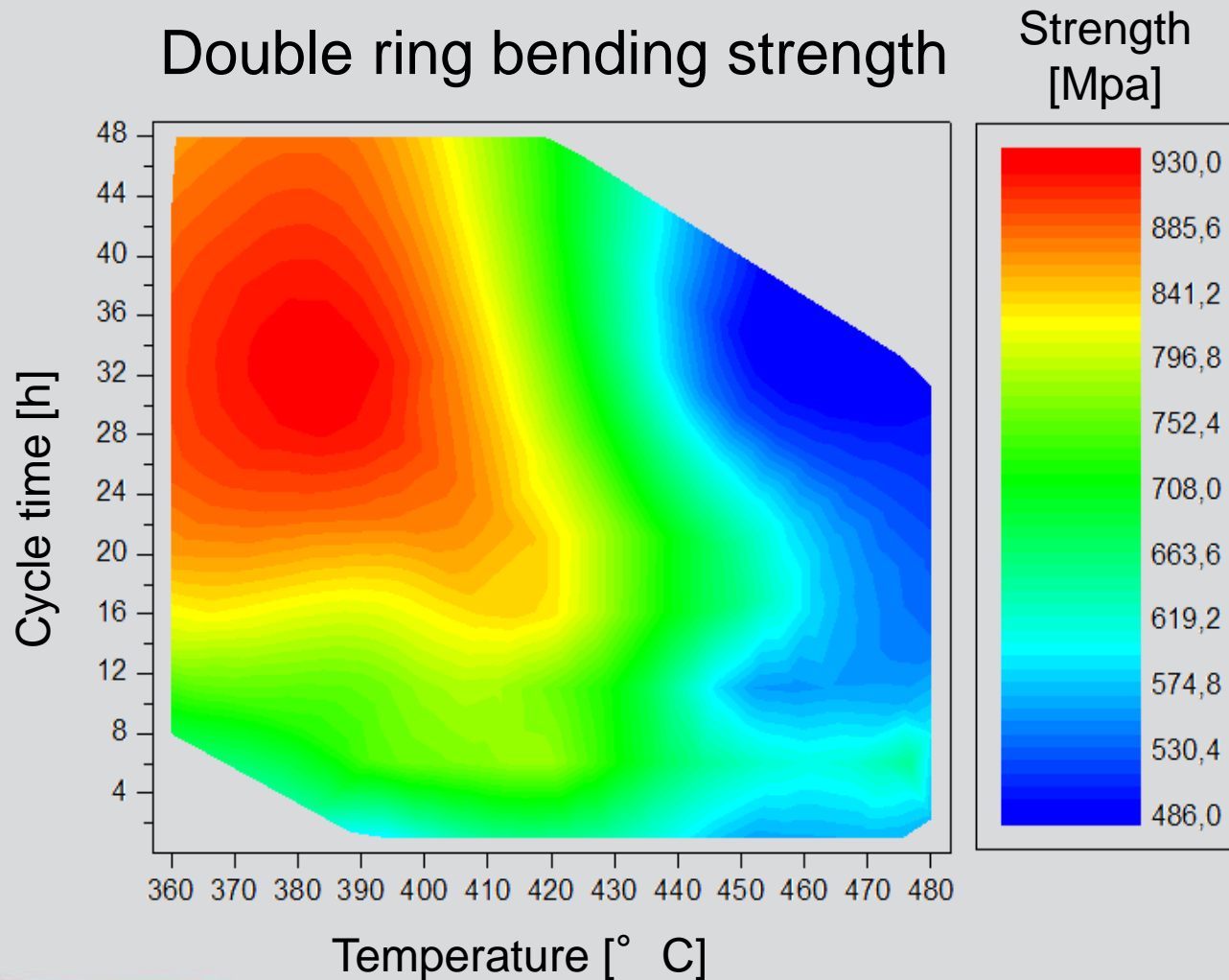

Values of DOL by

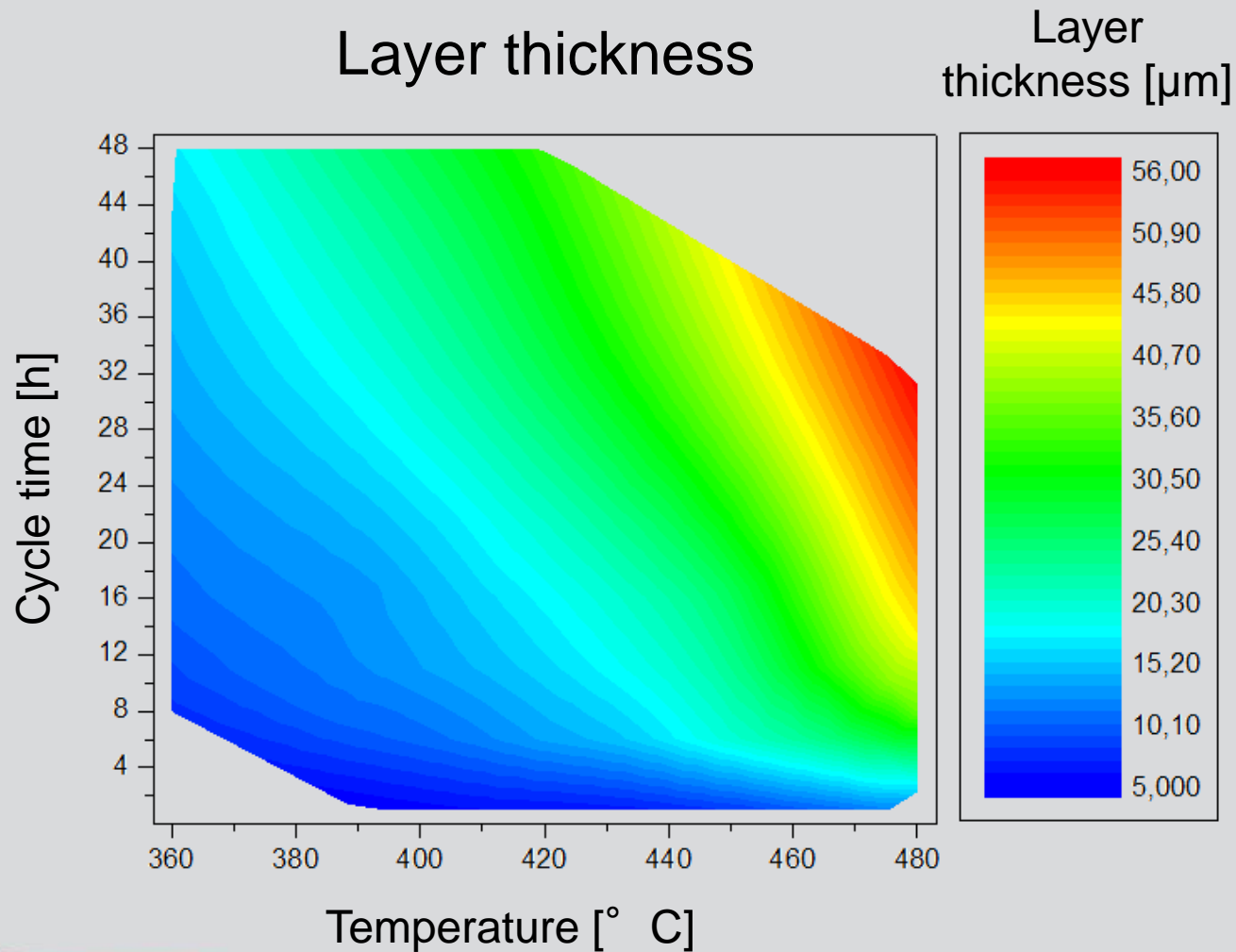



## **Advantage of chemical strengthening**

- High resistance against mechanical impact
- High resistance against scratches
- No optical distortion
- Tempering of thin glass possible

## **Applications**

- Display and cover glass
- Car interior
- Automotive glazing (light weight)
- High speed trains and cars
- Boats and Yachting
- Military applications
- Security glass and fire protection doors
- Architectural glass
- Aircraft industry
- Table ware
- Optical glass

## Technological process

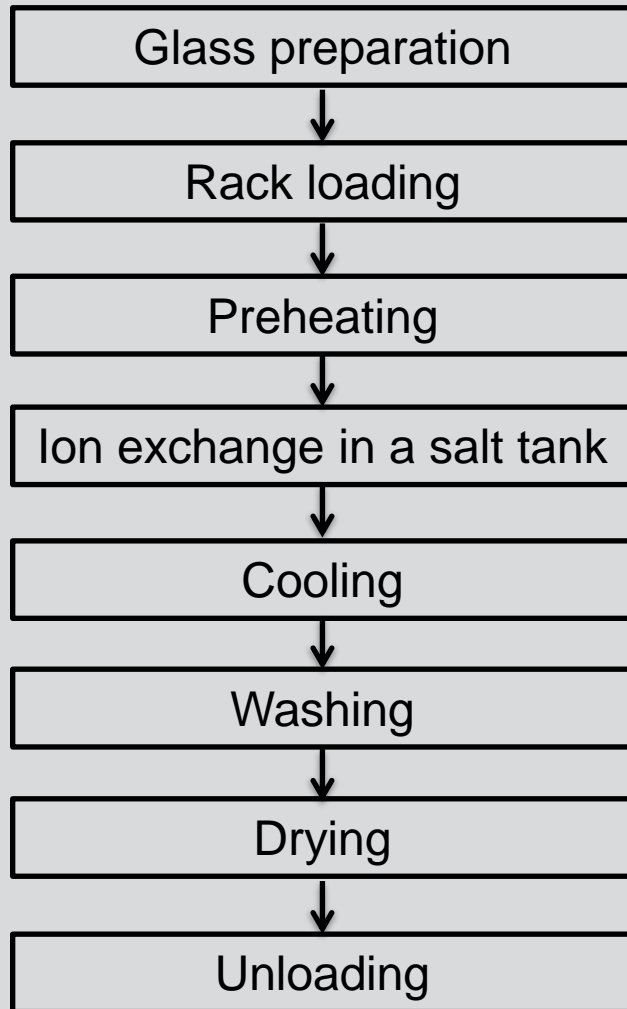



## Cross section

### 1. Rack:

carry the glass sheets  
clip solution (patent-registered)

### 2. Preheating / Cooling chamber:

electric heated oven with  
forced air convection

### 3. Door:

covers the tank and the  
chamber

### 4. Tank:

includes the heating for the  
molten salt  $\text{KNO}_3$

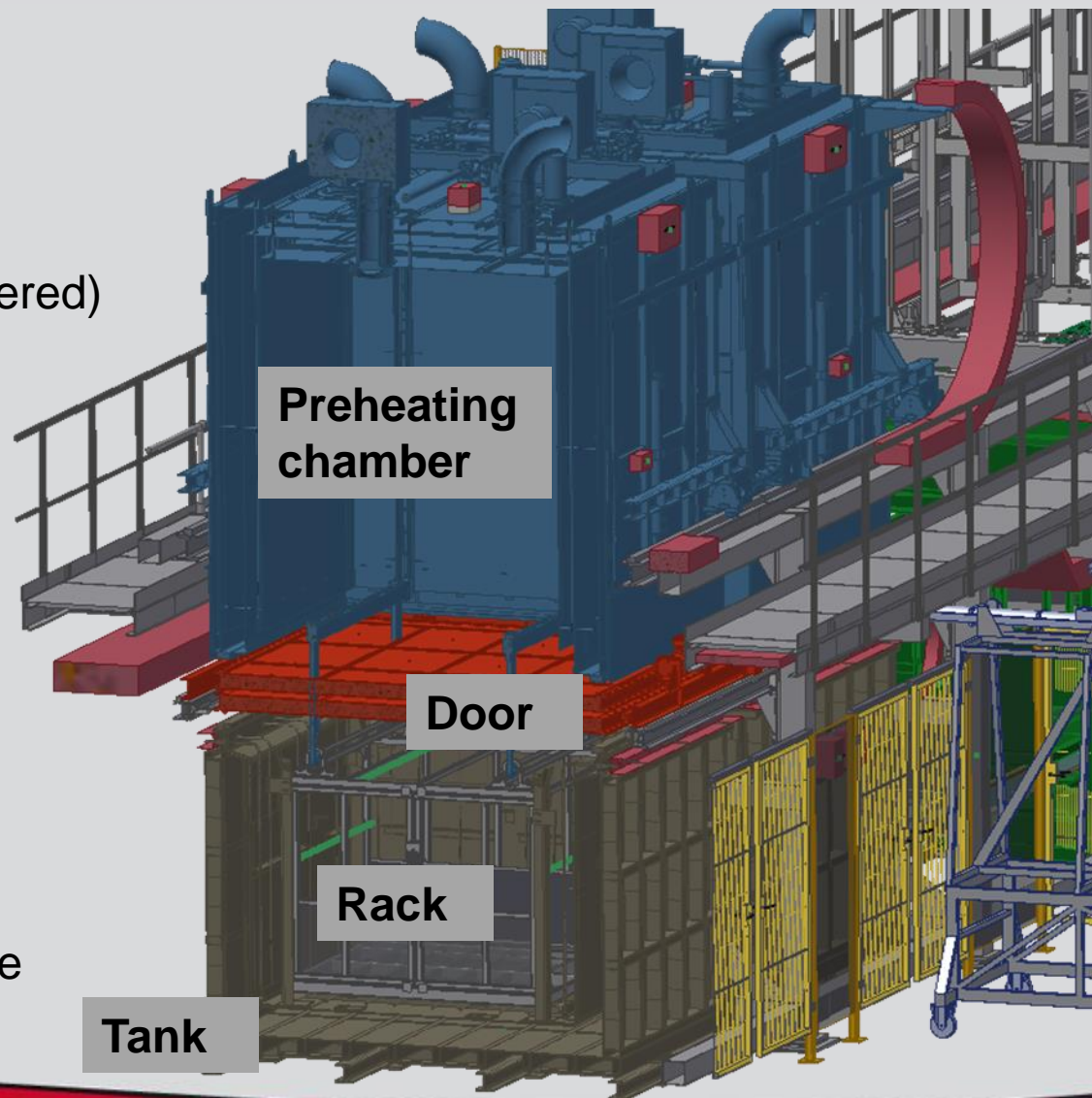

## CHEMICAL STRENGTHENING OF GLASS

Our chemical strengthening lines are noted for their

- functioning and robustness
- low energy consumption
- high degree of automation
- ease of operation
- low maintenance cost

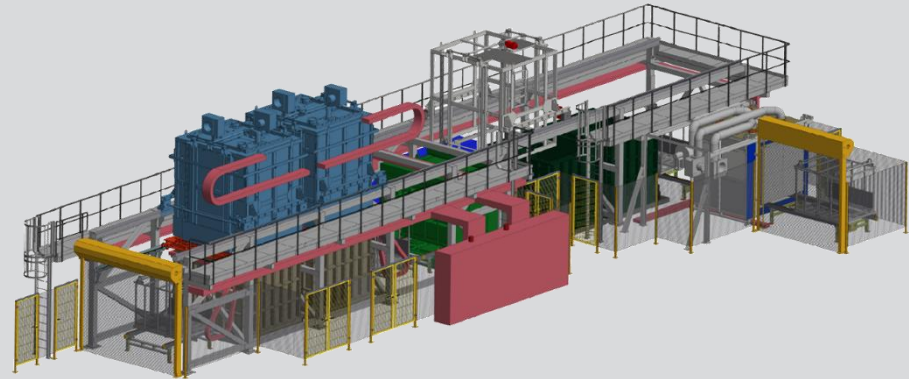

**Fully automatic batch process  
capable for single glass sheets and  
small series of glass sheets**

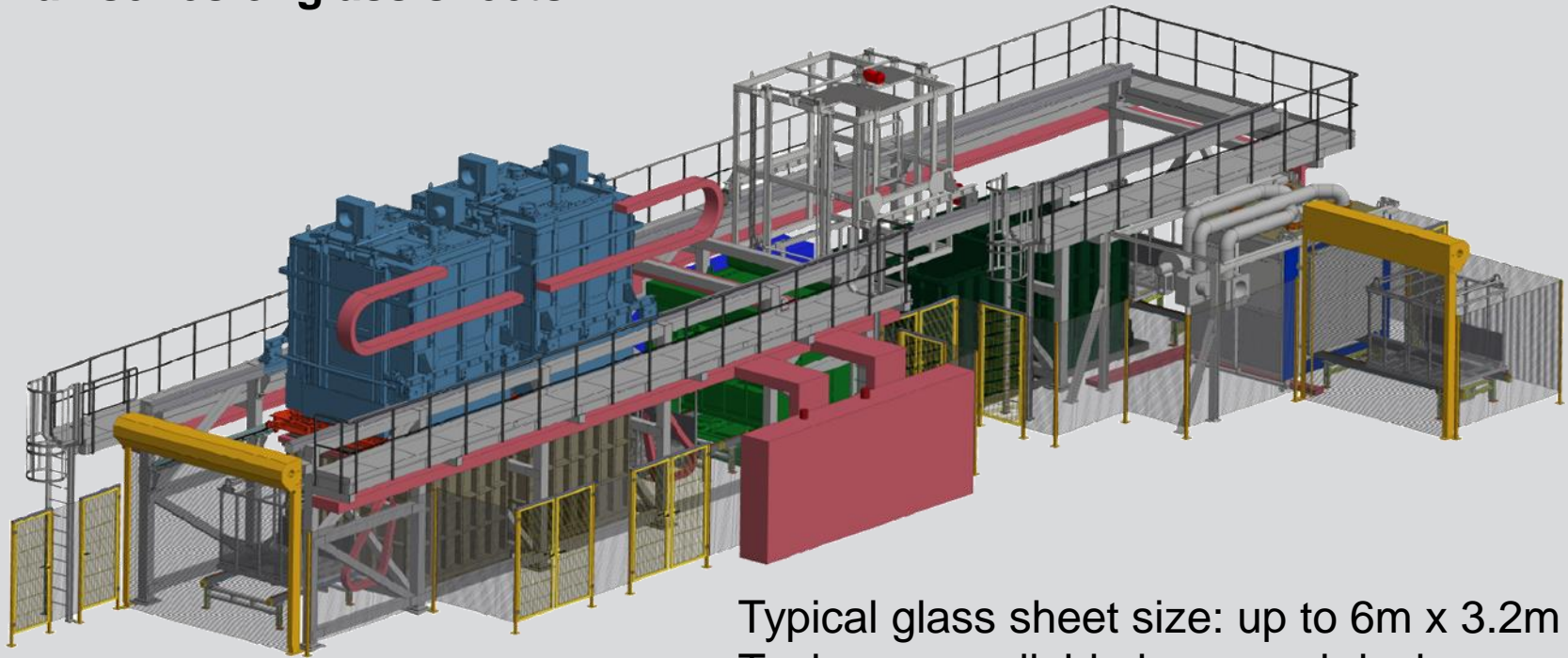

Typical glass sheet size: up to 6m x 3.2m  
Tanks are available in several design  
sizes.



## Layout: fully automatic lines for mass production in automotive glass

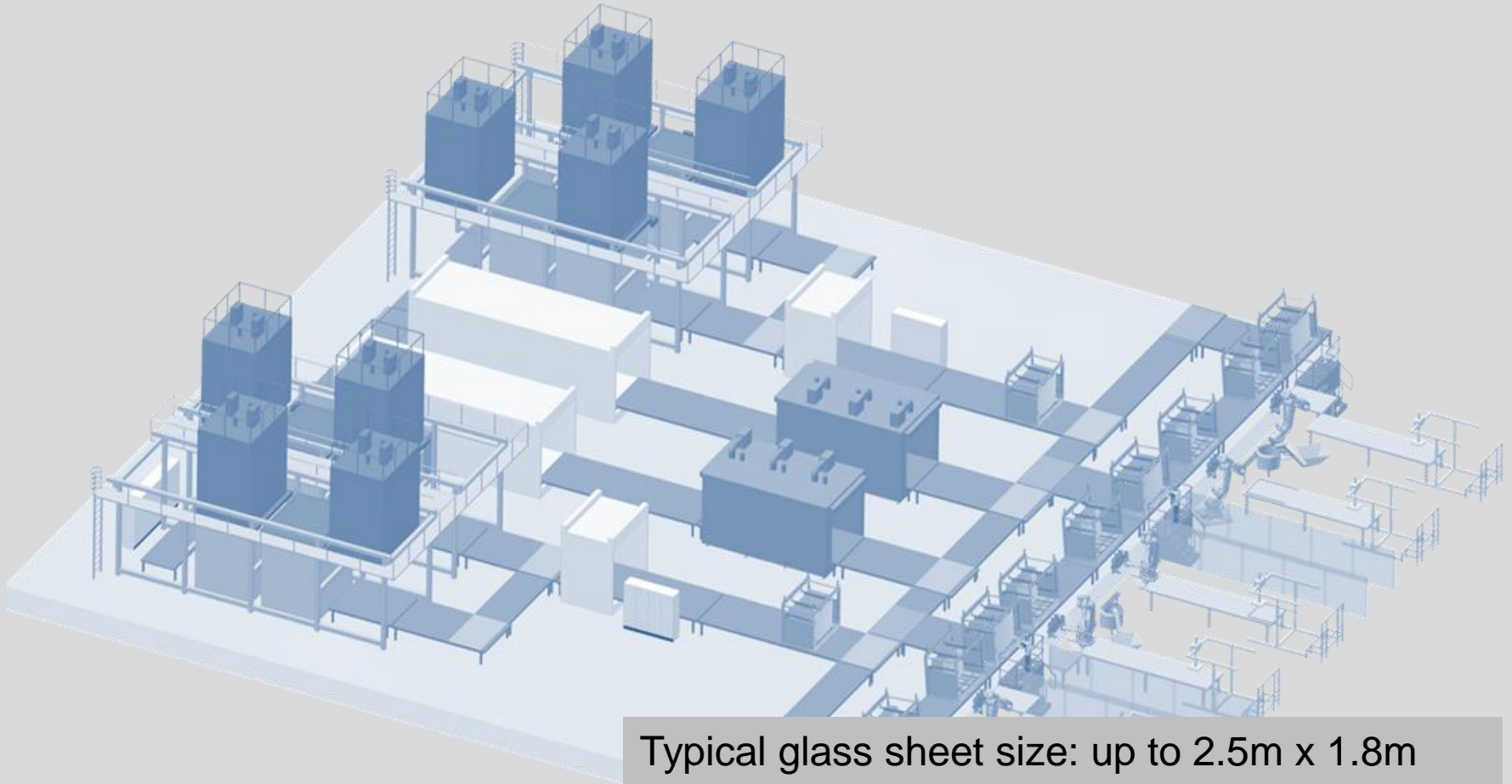

Typical glass sheet size: up to 2.5m x 1.8m  
Tanks are available in 3 design sizes.

## Layout: full automatic lines for mass production

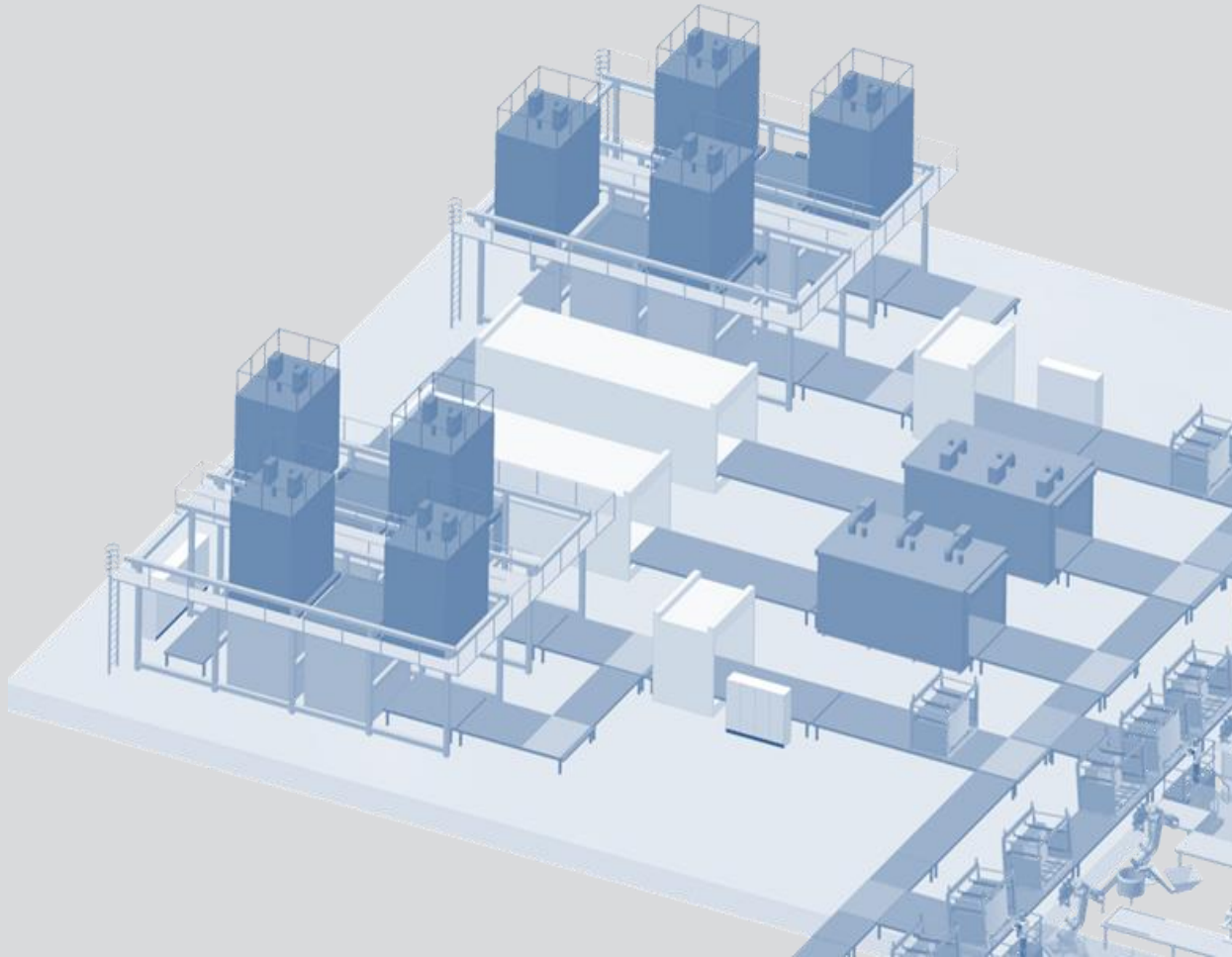

**Loading  
of thin glass sheets  
into the rack by robot  
include tracking of  
glass sheets**

## Layout: full automatic lines for mass production

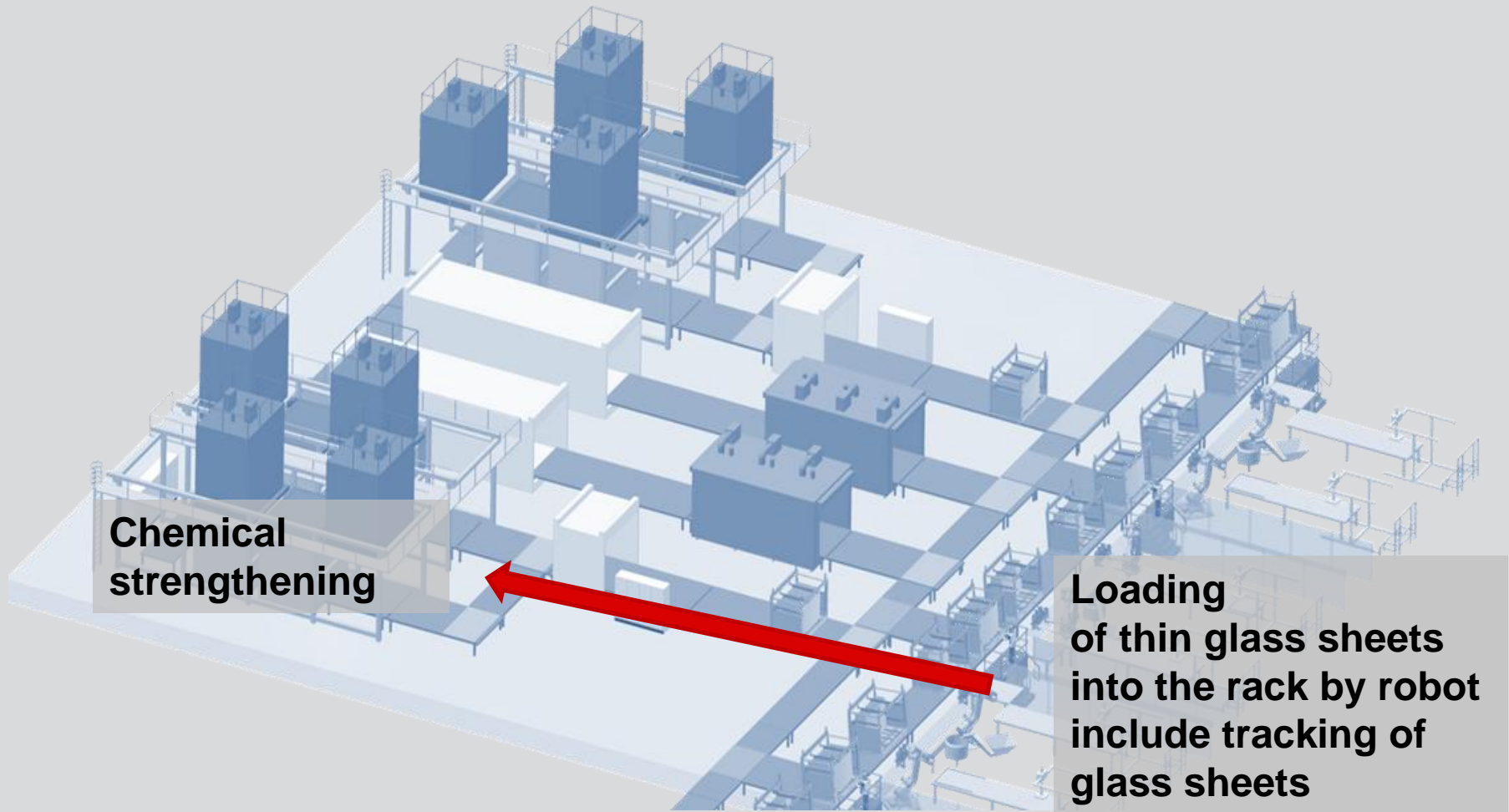



## Layout: full automatic lines for mass production

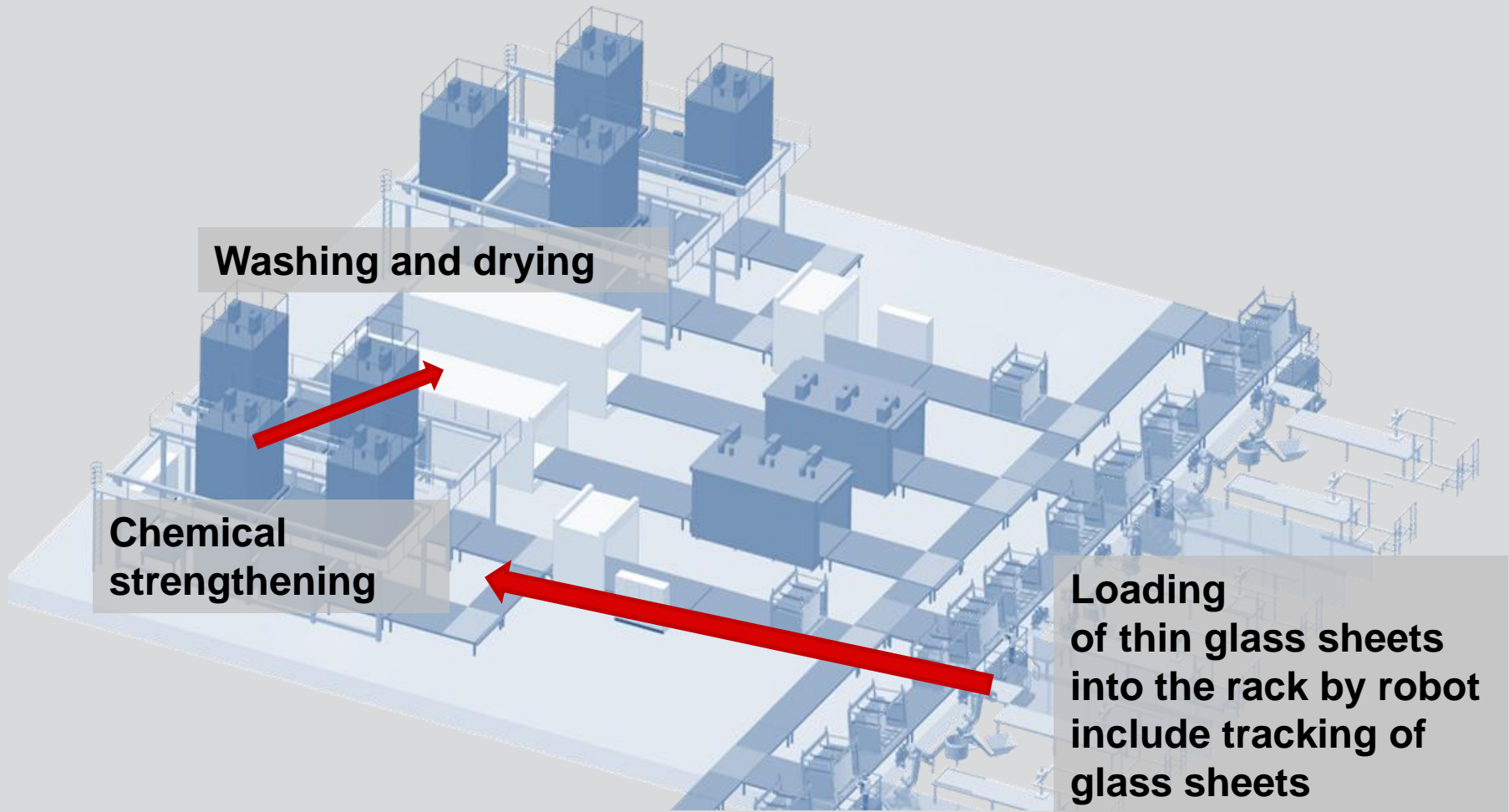

## Layout: full automatic lines for mass production

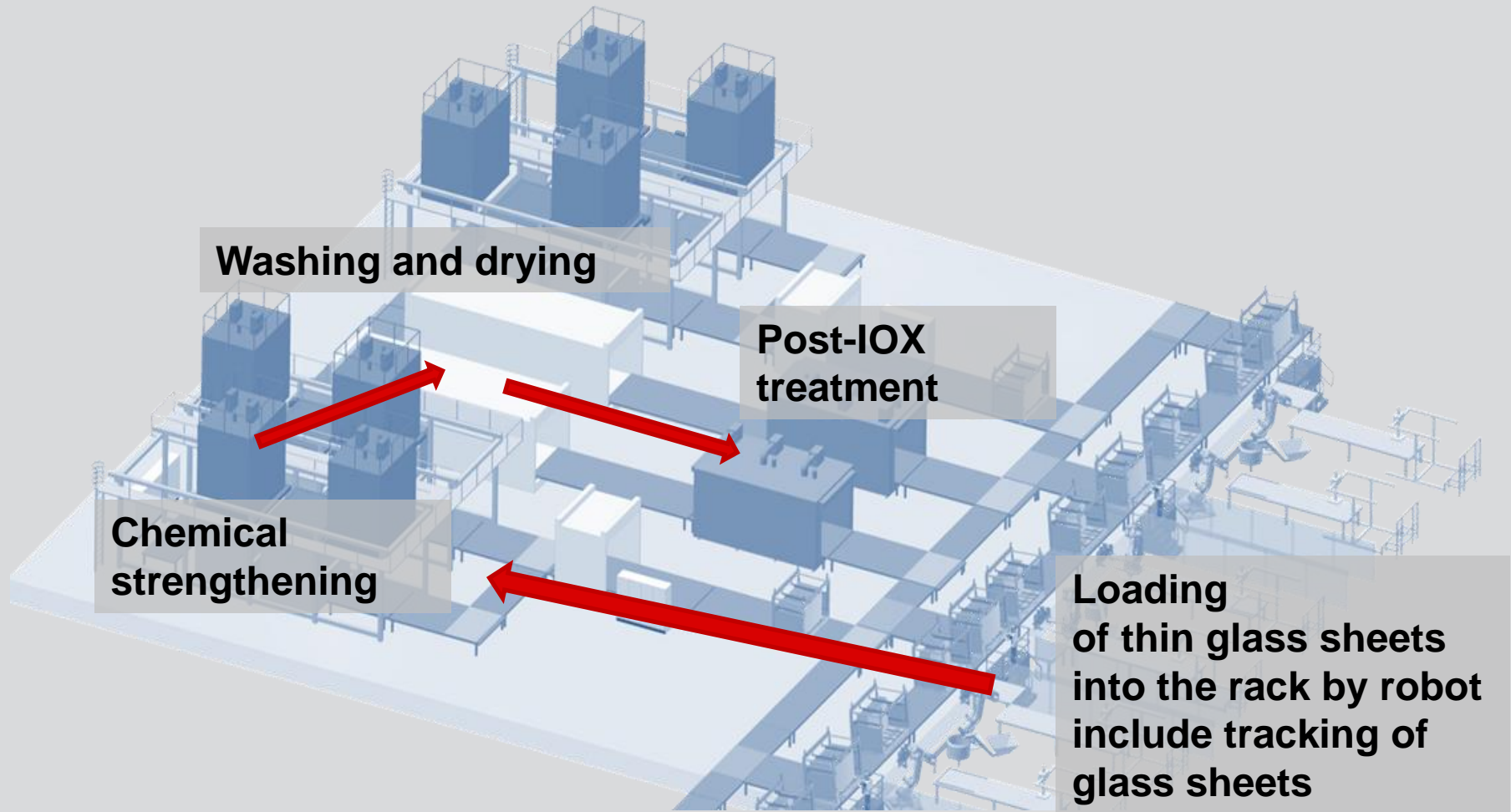

## Layout: full automatic lines for mass production

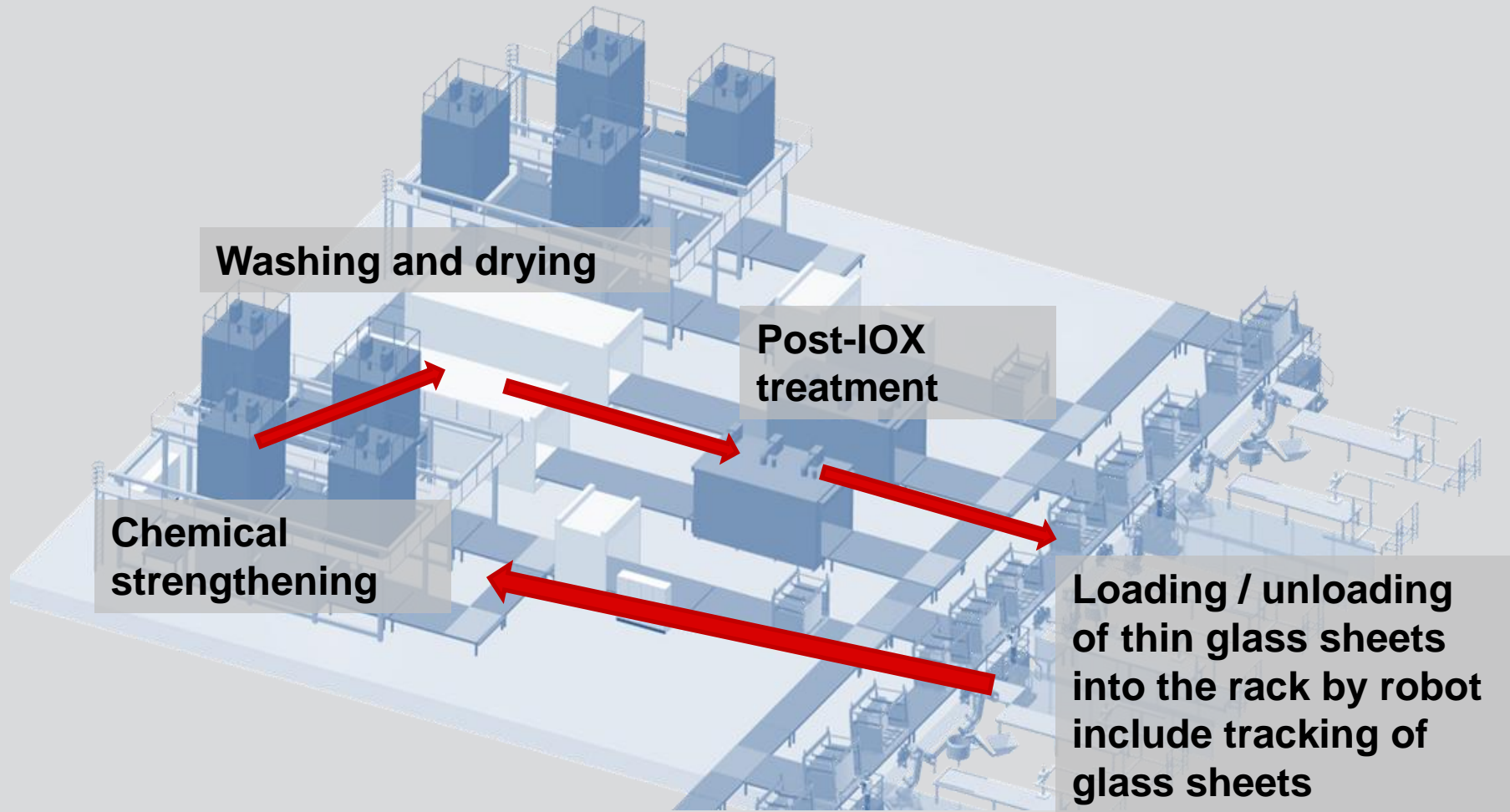



## Robot handling for thin glass application with vision system

Glass thickness: 0.5mm to 1.6mm

Glass size: up to 2200mm x 1600mm

Cycle time: approx. 30 sec/ pc.

Options: de-pairing of glass sheets after bending

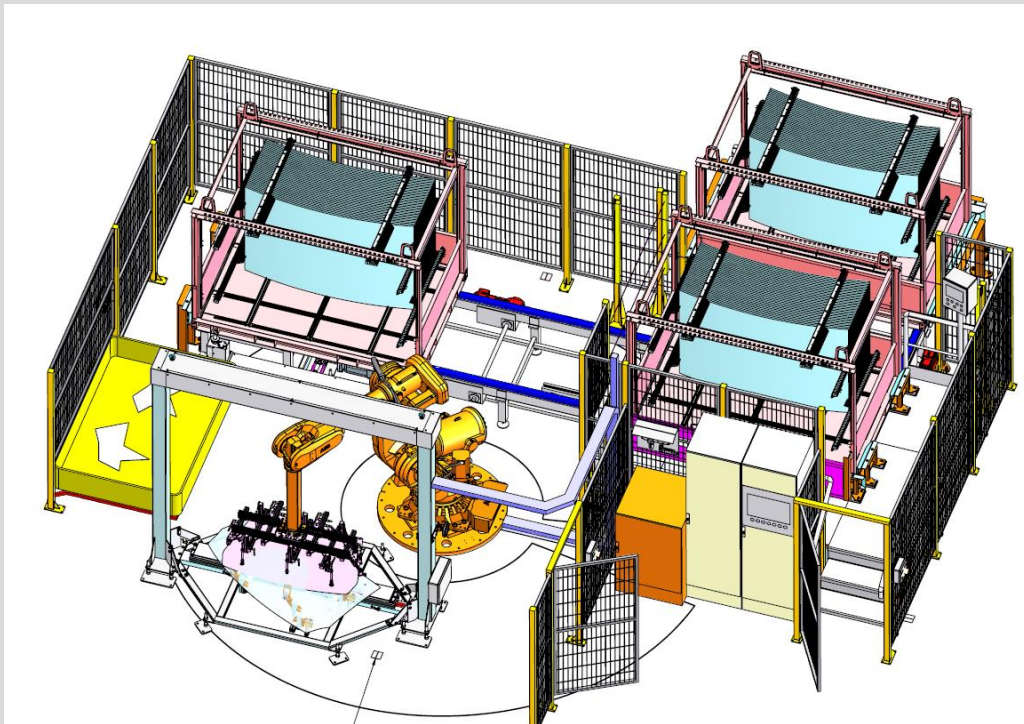

## Washing



Shower tunnel



Warm water

Deionized water

## Salt handling



Salt filling



Salt drainage valve



## Forecast: Continuous processing in salt bath

If the demand of automotive glass is increasing strongly then new concepts are needed. We are ready to supply.

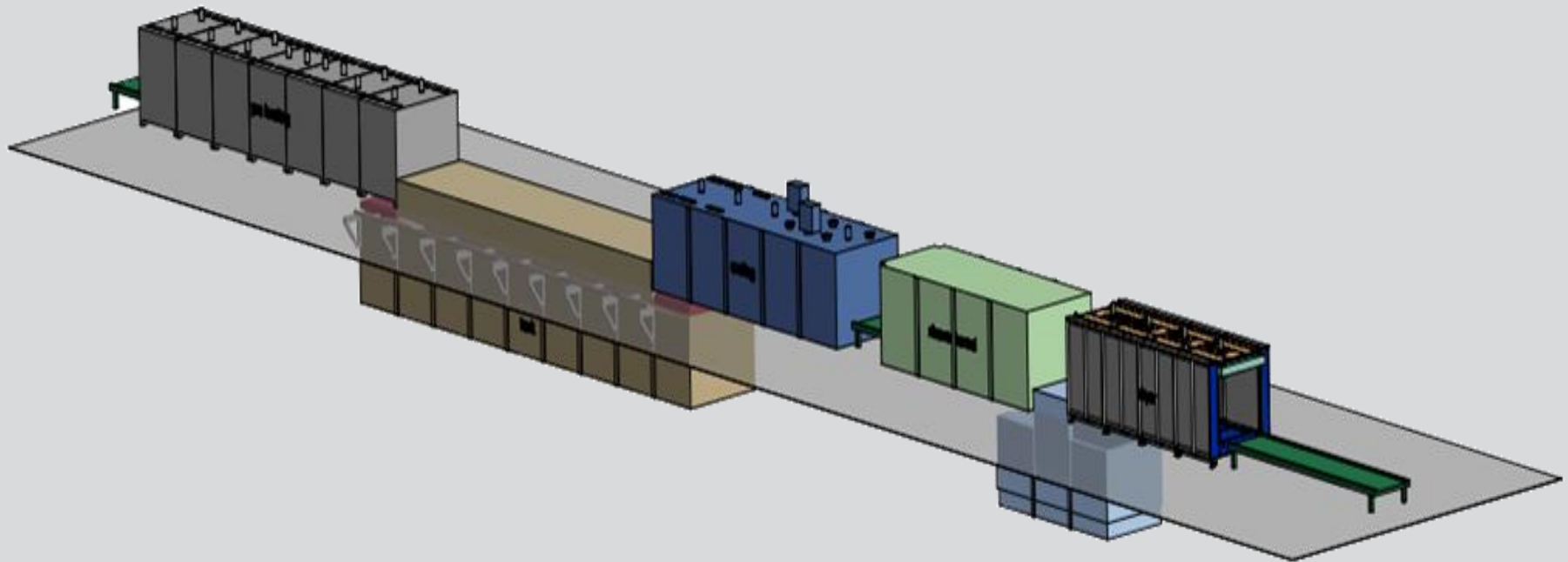

## Research and Development

- continuous processing in salt bath
- salt regeneration
- spray coating  
new technology for mass production
- Test facilities for chemical strengthening are available

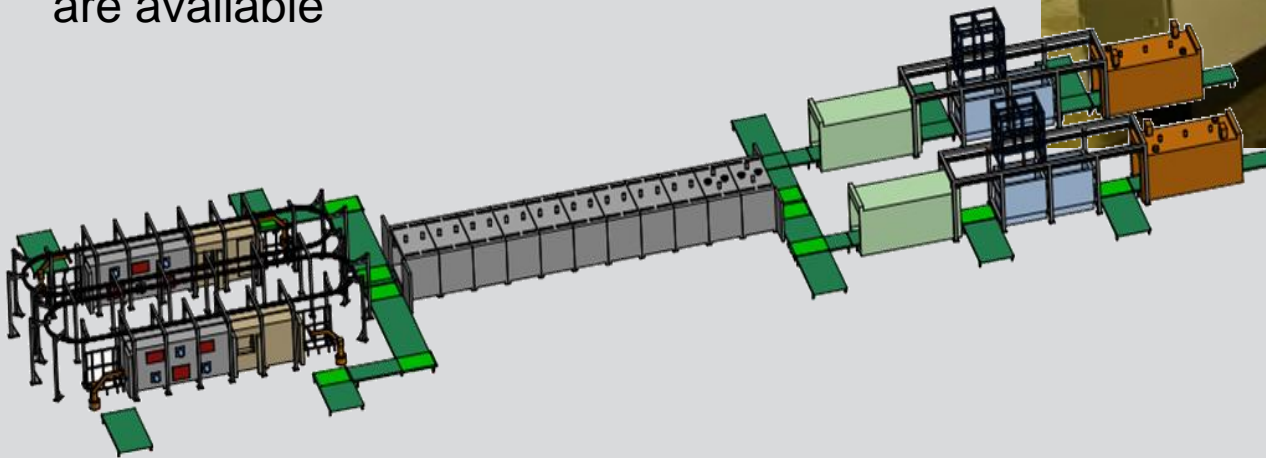

## TECHNICAL CENTER in JSJ and GLAMACO

- Glass melting services
  - Melting tests and raw material assessments
  - Melting technology investigations
  - Measurement of physical properties of glass melts (el. conductivity, viscosity)
  - Corrosion tests (refractory and electrode materials)
- Glass production on customer request
- Test facilities for chemical strengthening
- Tempering test facility
- Laser cutting test station LHC, LCC for table ware
- Laser supported bending test facility



# THANK YOU FOR YOUR ATTENTION.

See you at German Pavillion stand C43

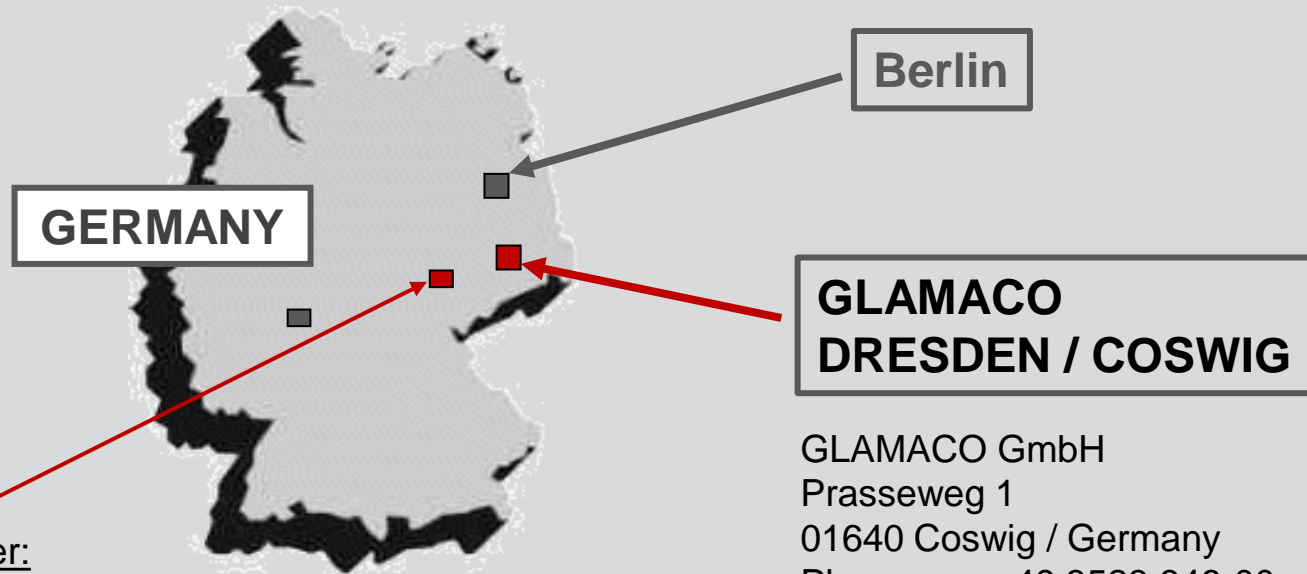

Business Partner:

JSJ Jodeit GmbH  
Am Nasstal 10  
07751 Jena / Germany  
Phone: +49 3641 6229-20  
E-Mail: [jodeit@jsj.de](mailto:jodeit@jsj.de)  
Internet: [www.jsj.de](http://www.jsj.de)

**GLAMACO  
DRESDEN / COSWIG**

GLAMACO GmbH  
Prasseweg 1  
01640 Coswig / Germany  
Phone: +49 3523 646-00  
E-Mail: [info@glamaco.com](mailto:info@glamaco.com)  
Internet: [www.glamaco.com](http://www.glamaco.com)